



The PARAFLEX Umbrella System Installation and Operating Instructions

Introduction:

The PARAFLEX Umbrella System consists of three main components:

- A mounting track or post, which can be wall mounted or free standing
- A multi-adjustable, hinged umbrella holder arm
- An aluminum frame umbrella, available in 7' or 9' diameter

1. Mounting the Hinge to the Track

Before either the wall mount or the telescoping support post can be installed, the hinge(s) connecting the holder arm(s) and the mount must be installed in the support track. In case of a wall mounted unit, this step may already have been completed in the factory.

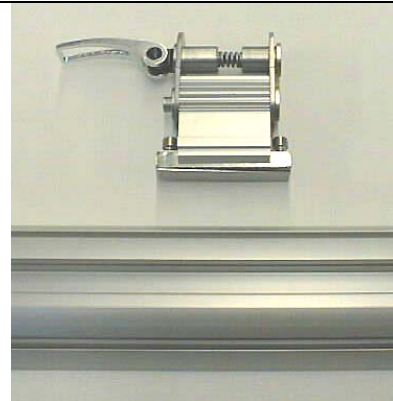

1a. Mounting the Hinge to a Wall Mount

- Remove end cap from wall mount track and slide the hinge into the grooves of the wall mount.
- Please note: When mounted, lever must face **downwards** for easy operation.

- Lock the hinge in position by firmly tightening the two allen screws as shown. Use the enclosed short-arm allen wrench to do this. After mounting the wall mount, you will have a height adjustment range of about 8" for the hinge.

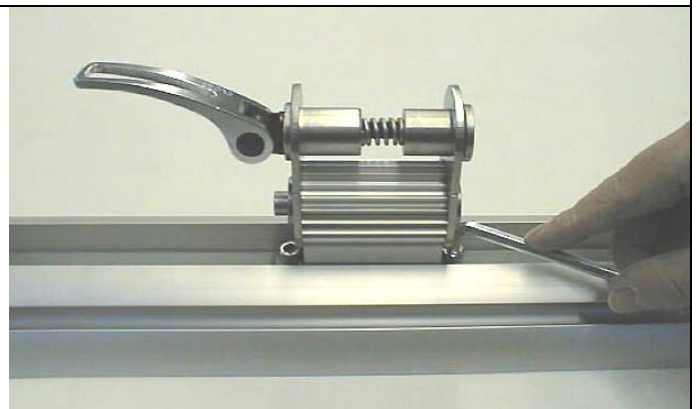



1b. Mounting the hinge to the telescoping pole

- Remove safety pin and pull out the aluminum locking pin from the pole.

- Extend the pole to the desired length. Use the pre-drilled holes for height adjustment, and insert the locking pin. Be sure to secure it with the safety pin against accidental removal. Should a specific height be required, such as, to fit a certain ceiling height, you may drill the appropriate holes into the upper (smaller dia.) extrusion with a 3/8" drill bit along the existing holes

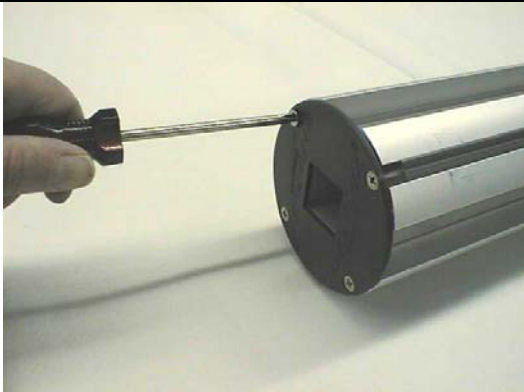
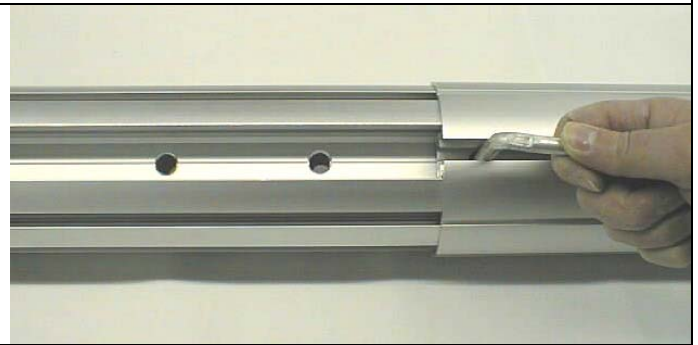

- Remove the pole cover cap

- Slide the hinge(s) into the track(s). There are four tracks available on the upper pole. Make sure the lever faces **downwards**.
- Secure the hinge in the track as described in section 1b.

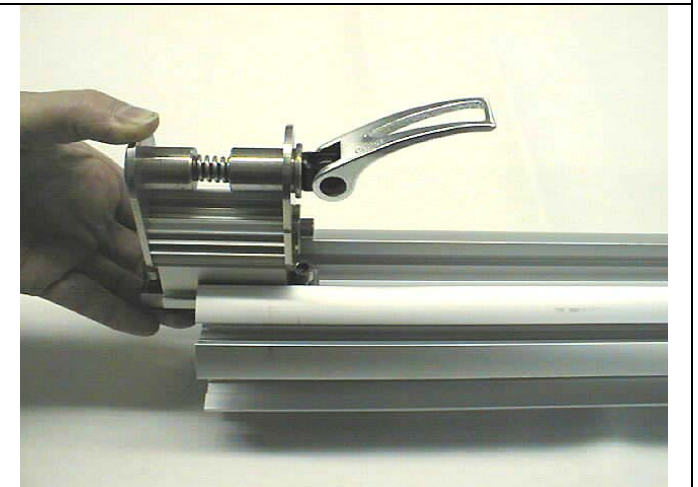

2. Mounting the Track or Pole

2a. Mounting the Wall Mount

- The wall mount must only be fastened to a solid, secure surface, such as
 - a brick wall
 - a framed wall, directly bolted into the wall studs
 - a solid post, minimum size 4"x4", and well supported
- Bolts must be minimum 3/8" x 4", galvanized or stainless steel.
- If uncertain about any of the above please contact a certified building contractor.
- The wall mount should be mounted at a height allowing a clear passage of about 6'8" underneath the holder arm. Once mounted, the bracket allows for a height adjustment range of about 8"

2b. Mounting the Telescopic Pole

- Regardless of the mounting option you have chosen for your pole (freestanding flower box mount, concrete mount, triangular surface mount plate, installation instructions for which are supplied with the individual base), your pole is always mounted to a square support tube.
- Extend pole as described in section 1b.
- Slide pole over the steel support tube. The support tube must be inserted **all the way !**

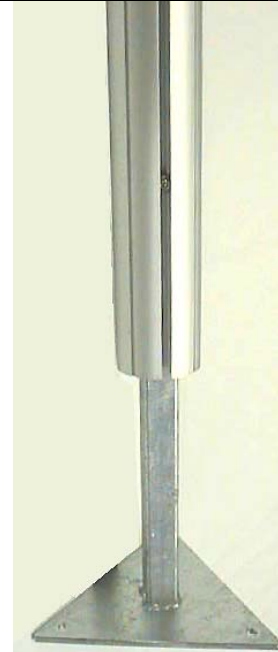

- Tighten both security bolts firmly with the enclosed allen wrench.
- **CAUTION: Check this step carefully, as this secures the pole from being pulled off the base in windy conditions**

3. Attaching the Umbrella Holder

You are now ready to attach the umbrella holder(s) to the hinge(s)

- Loosen the hinge bolt opposite the lever

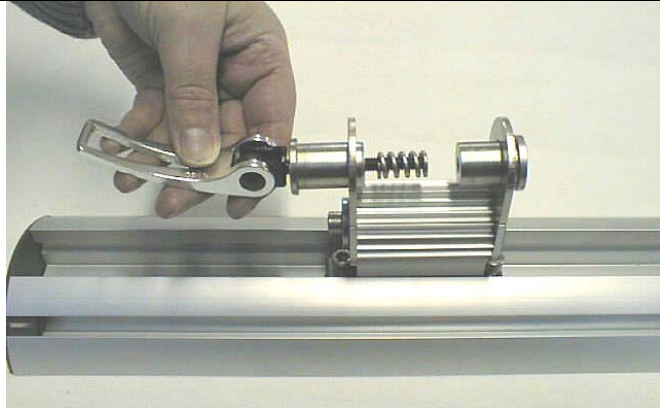
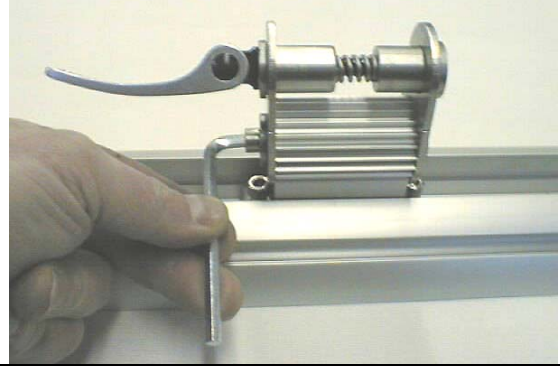

- Turning counter clockwise, unscrew the lever and pull out bushing, lever and spring from the bottom plate

- Rotate the bottom plate sideways and push up the top bushing through the top plate

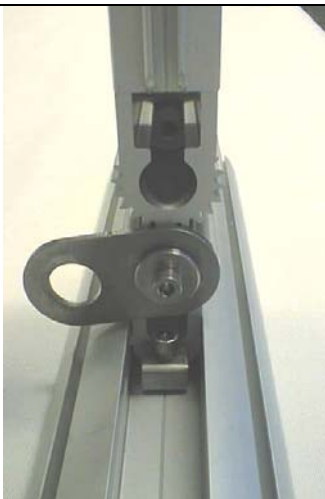

- Insert the umbrella holder
- Align the gears of the umbrella holder with the gears of the hinge. Make sure the holder is not inserted at an angle, but rather oriented in a straight line with the hinge as shown in the picture
- Slide the top bushing into the holder

- Rotate the bottom plate back into position.

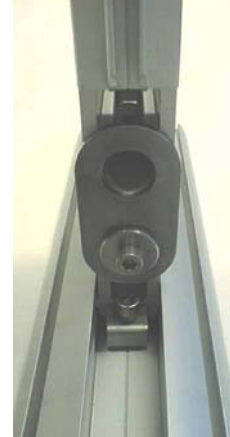

- Insert spring, bushing and lever, and tighten clockwise.

- Firmly tighten the hinge bolt opposite the lever on both hinges of the arm.

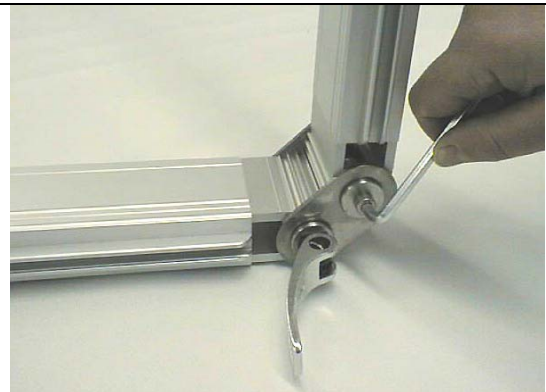

Open

Closed

- Left image shows the adjustment lever in release position.
- To lock the hinge in position, rotate the lever clockwise in release position, then flip the lever.
- Optimum friction adjustment is achieved when it requires firm pressure to push the lever into horizontal position as shown on the right.
- To adjust the arm in any position,
 - open the hinge lever, then move to desired position
 - close lever to lock arm in desired position

4. Inserting the Umbrella into the holder

You are now ready to set the umbrella into the holder arm.

- Set the lever into the slot of the holder bracket as shown, and push it in firmly to snap it in place

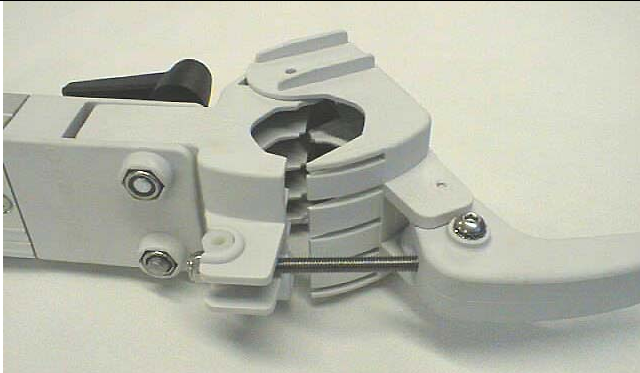

- Seat the cross dowel firmly into the slot of the holder as shown

- Insert the umbrella into the holder and snap the lever shut. The tension is correct if you are unable to twist the umbrella pole by hand when the clamp is locked.
- **CAUTION: Be careful to familiarize yourself with the force of the lever when closing, to avoid pinching your fingers !**
- The lever comes factory adjusted for optimum pressure. However, should re-adjustment be necessary, simply loosen the lock nut, turn the cross dowel to the required tension, and tighten the lock nut to sit firmly against the cross dowel.



5. Tilting the Umbrella

- Release the black lever on the holder bracket by turning it counter clockwise

- Tilt the umbrella to the desired angle
- Tighten the handle firmly to lock tilt position

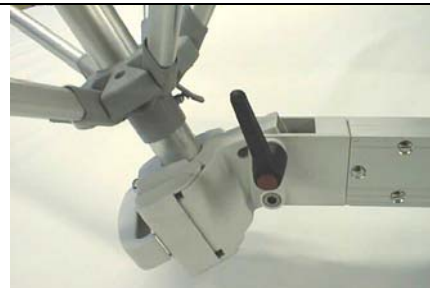



6. The Pole Top Umbrella Holder

The Pole Top Holder is a fixed umbrella mount for the top of the telescoping pole

- Release the fastening screw at the top of the upper pole with the enclosed allen key

- Slide Umbrella Holder into top pole
- Tighten the locking bolt firmly. **Check this step carefully to prevent the umbrella holder from being lifted out of the pole by strong winds**
- Insert umbrella as described in section 4.

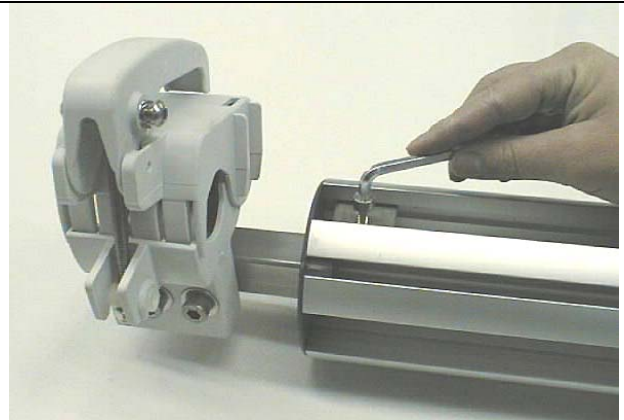

7. Storing your umbrella

When not in use, remove umbrella, collapse, and fold holder up against the wall.

Umbrella can be stored by hanging it with the D-ring from the hook on the underside of the holder.

A storage bag with draw string closure and a D-ring for hanging is available as accessory, and will keep the umbrella fabric clean and protected while stored.

Make sure umbrella fabric is dry when storing for extended periods of time in the storage bag.



8. General Instructions

- PARAFLEX Umbrellas are rated for use in up to 25mph wind for 9' umbrellas, 30mph for 7' umbrellas (locked in **horizontal position**) under normal controlled conditions. In tilted position the umbrellas will catch the wind, and are therefore rated at **half** the above wind speeds. Note that wind is NEVER a constant force, and that wind gusts can be twice the average wind speed, without prior warning. It is therefore always recommended to remove the umbrella from the holder during the night, and whenever they are unattended for extended periods of time. Umbrellas must also be closed in the event of thunderstorms, hail or any other severe weather conditions. **Damage due to severe weather conditions is explicitly excluded from warranty coverage.**

- FIM uses only SUNBRELLA® acrylic outdoor fabrics, the premium U.S. made fabric for outdoor use today.

SUNBRELLA® will not rot or mildew, and features superb fade resistance in all conditions.

1. Fabric should be cleaned regularly before substances such as dirt, soot, roof particles etc. are allowed to accumulate on and become embedded into the fabric. The fabric can be quick-cleaned without being removed from the umbrella. Simply brush off any loose dirt particles; Hose down and clean with a mild solution of natural soap in lukewarm water (no more than 100°F/35°C)

Rinse thoroughly to remove soap. Open umbrella and allow to air dry.

2. Immediately wash out and rinse spots such as bird droppings or tree sap. If left on the fabric for extended periods, the fabric may become permanently stained.

3. At the end of each season, the umbrella cover should be thoroughly washed. Remove cover from umbrella frame (see assembly instructions). Wash cover in your household washer, set to 100°F/35°C, with IVORY Laundry Soap. DO NOT USE A LAUNDRY DETERGENT. Allow cover to air dry. DO NOT TUMBLE DRY AS THIS WILL DAMAGE THE FABRIC.

4. To restore water repellency after several machine washings, we suggest application of '303 Fabric Guard'. It is available at automotive and RV parts stores, or online from West Marine at www.westmarine.com

5. Never store the umbrella in damp condition. Make certain the fabric is absolutely dry when putting it into winter storage.

6. Consider using the optional PROTECTIVE UMBRELLA COVER (Code PTC/PF) to reduce required cleaning and extend the life of your umbrella's fabric. The umbrella inside the protective cover can also be stored on the storage hook of the umbrella holder arm.

Please call your FIM retailer or FIM Customer Service to order one.

9. Limited Warranty

FIM Manufacturing Inc. warrants to the consumer that this PARAFLEX product is free from manufacturer defects in material or workmanship for a period of two (2) years from the date of original purchase when used in compliance with directions as outlined in the manufacturer's instructions, which includes reasonable and necessary maintenance by the consumer. Failure to follow the given assembly, maintenance and care instructions may void your product warranty.

In case of manufacturing defects in material or workmanship, FIM Manufacturing Inc. agrees to, at their discretion, repair, remedy or replace any defective umbrella or awning part without charge for the first two (2) years from the date of original purchase.

To be covered under this warranty, claims and repairs must be made by/to the authorized FIM/PARAFLEX dealer most convenient to the consumer, or directly to FIM Manufacturing Inc. by calling 1-888-551-5221

As the consumer, you assume all cost incurred in shipping your unit to a repair location specified by FIM Manufacturing. The repaired unit/parts will be returned to the consumer freight prepaid.

Any implied warranty is limited in duration to the two (2) years provided in this, the only, expressed warranty.

EXCLUSIONS:

No responsibility is assumed for incidental or consequential damages.

Warranty does not cover any damage due to improper installation, adverse weather conditions, Severe wind, misuse, neglect, lack of reasonable maintenance, or the use of any unauthorized attachments.

Warranty is void if unit is subjected to unauthorized service by anyone other than a FIM/PARAFLEX dealer or FIM Manufacturing Inc. themselves. Authorization may be obtained by calling the toll-free number below.

For umbrellas used in commercial/contract applications the warranty period is one (1) year from installation date.

PARAFLEX 201 Umbrella Holder Component List

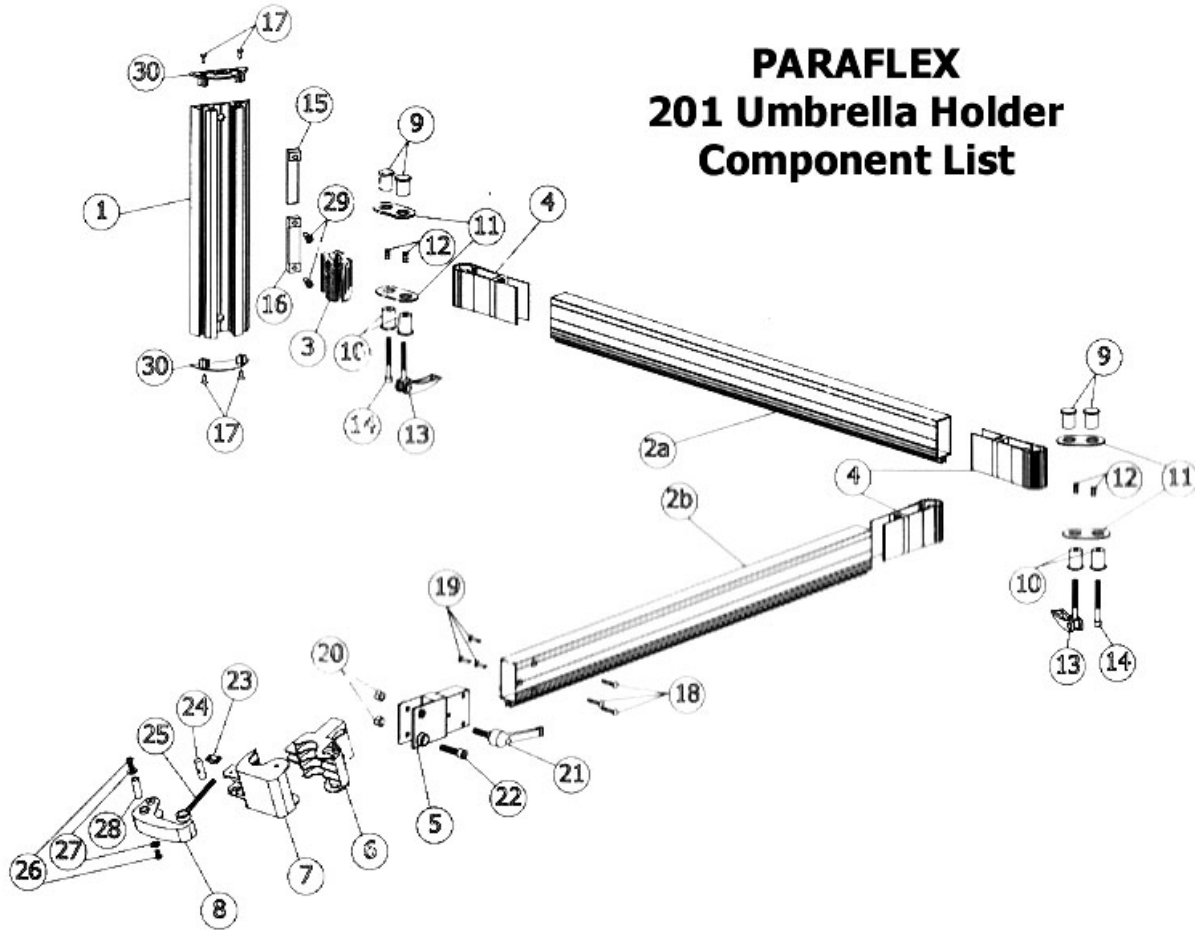

ID#	Part Description	ID#	Part Description
1	12" Aluminum wall mount track	16	Track slide pressure plate
2a	Holder extrusion – inside	17	Screws for end cap
2b	Holder extrusion – outside	18	Stainless bolts for holder insert
3	Track side gear extrusion	19	Stainless insert nuts for holder insert
4	Press-in gear extrusion	20	Stainless locking nuts M8 for pivot grip
5	Nylon grip holder insert	21	Pivot adjustment lever M8
6	Grip clamp pivot	22	Stainless pivot locking bolt M8
7	Grip clamp jaw	23	Stainless locking nut M5 for grip adjustment
8	Grip clamp lever	24	Cross dowel for tension adjustment
9	Stainless top bushing w/inside thread	25	Stainless eye bolt M5x90 for tension adjustment
10	Stainless bottom bushing w/hole	26	Stainless mushroom head screw M5x20
11	Stainless bushing plate	27	Stainless star lock washer
12	Spring	28	Threaded sleeve for eye bolt
13	Locking lever M6	29	Stainless set screws for pressure plate
14	Hinge bolt M6x50	30	Nylon end cap, grey for wall mount track
15	Track slide protector plate		